

New Gen mask is a prototype model which is not 3d printed and tested yet. Thickness, sizes and shapes can be change after testing the prototype.

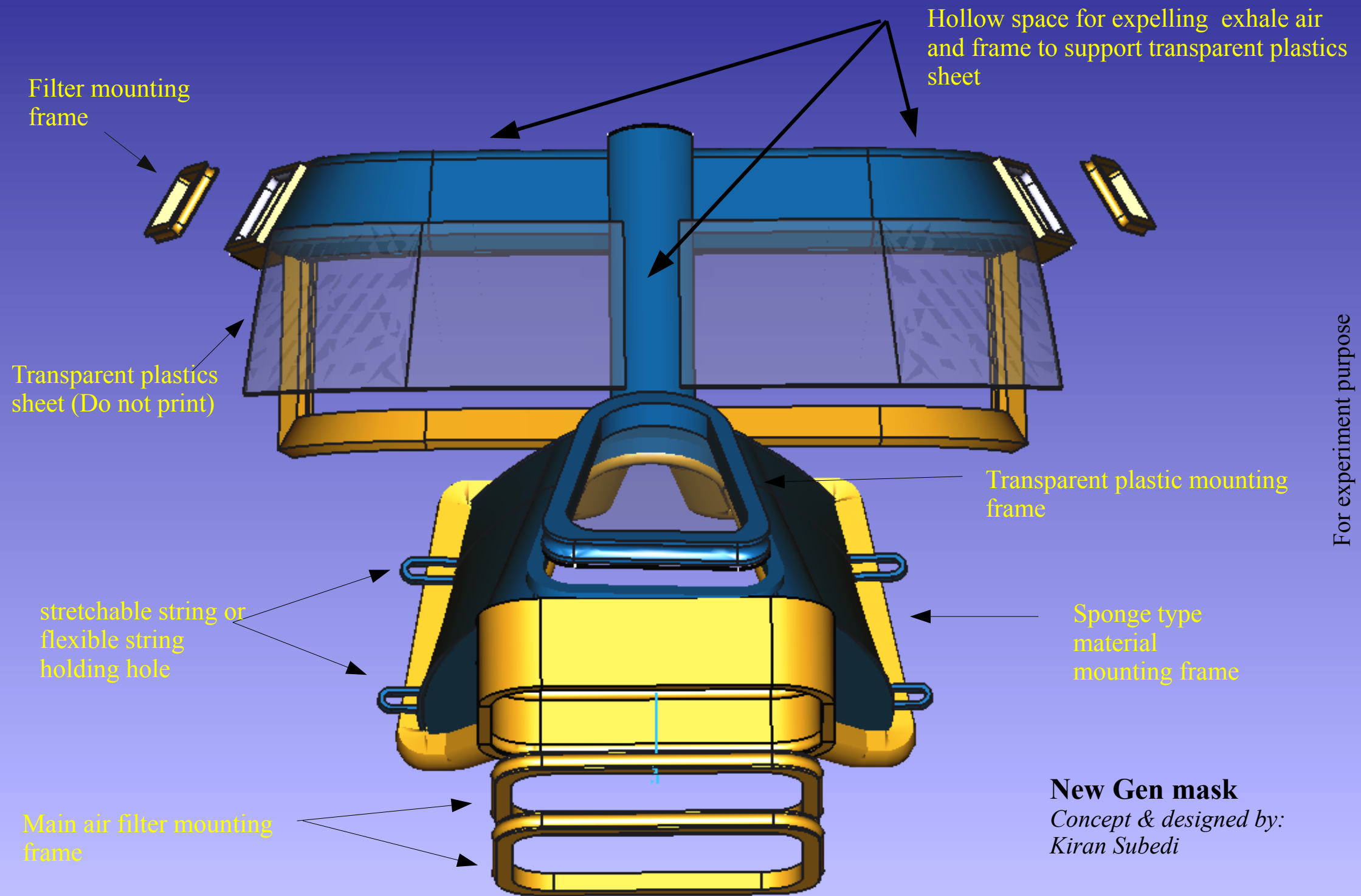

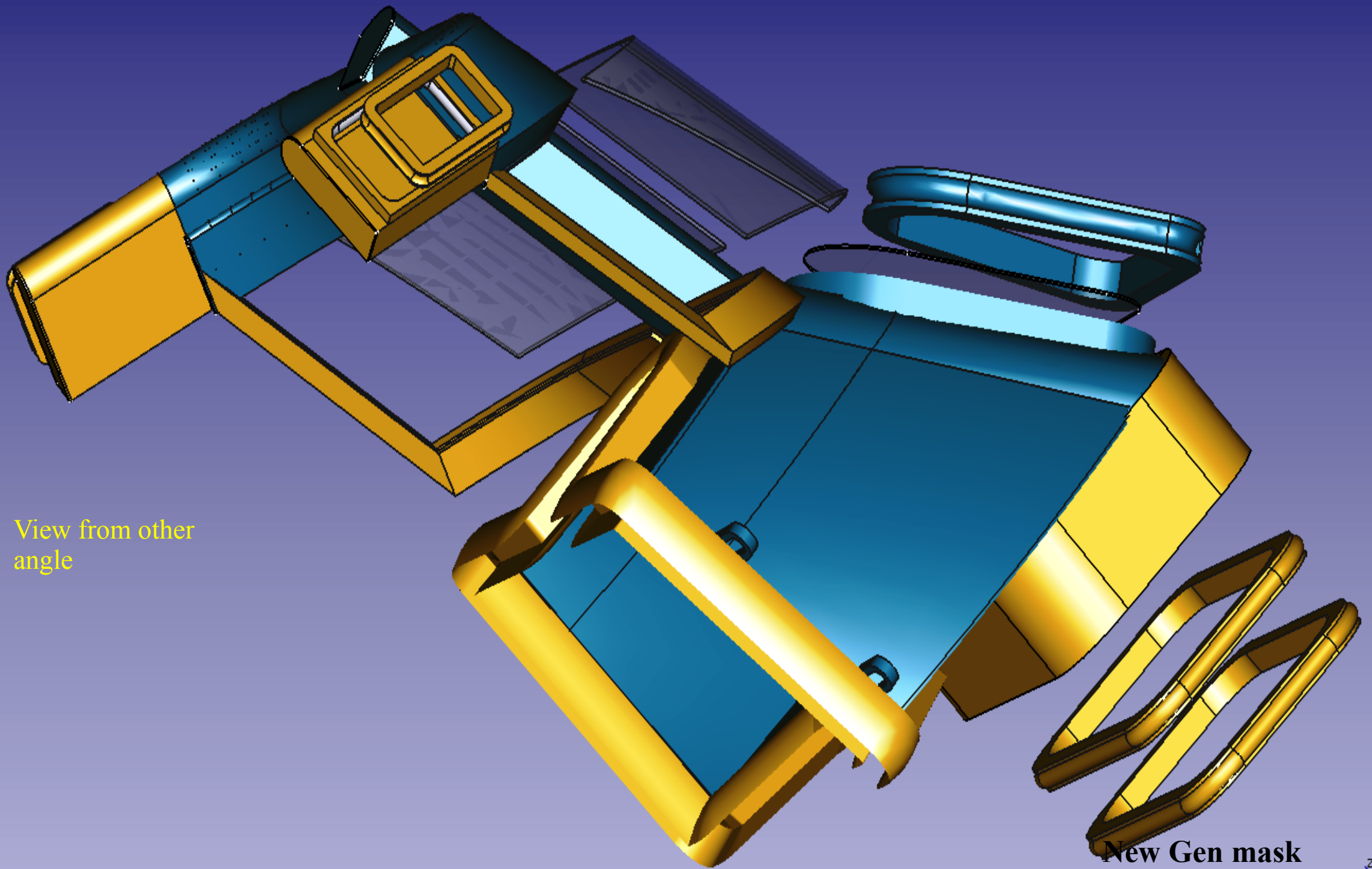

View from other  
angle

For experiment purpose

**New Gen mask**  
Concept & designed by:  
Kiran Subedi



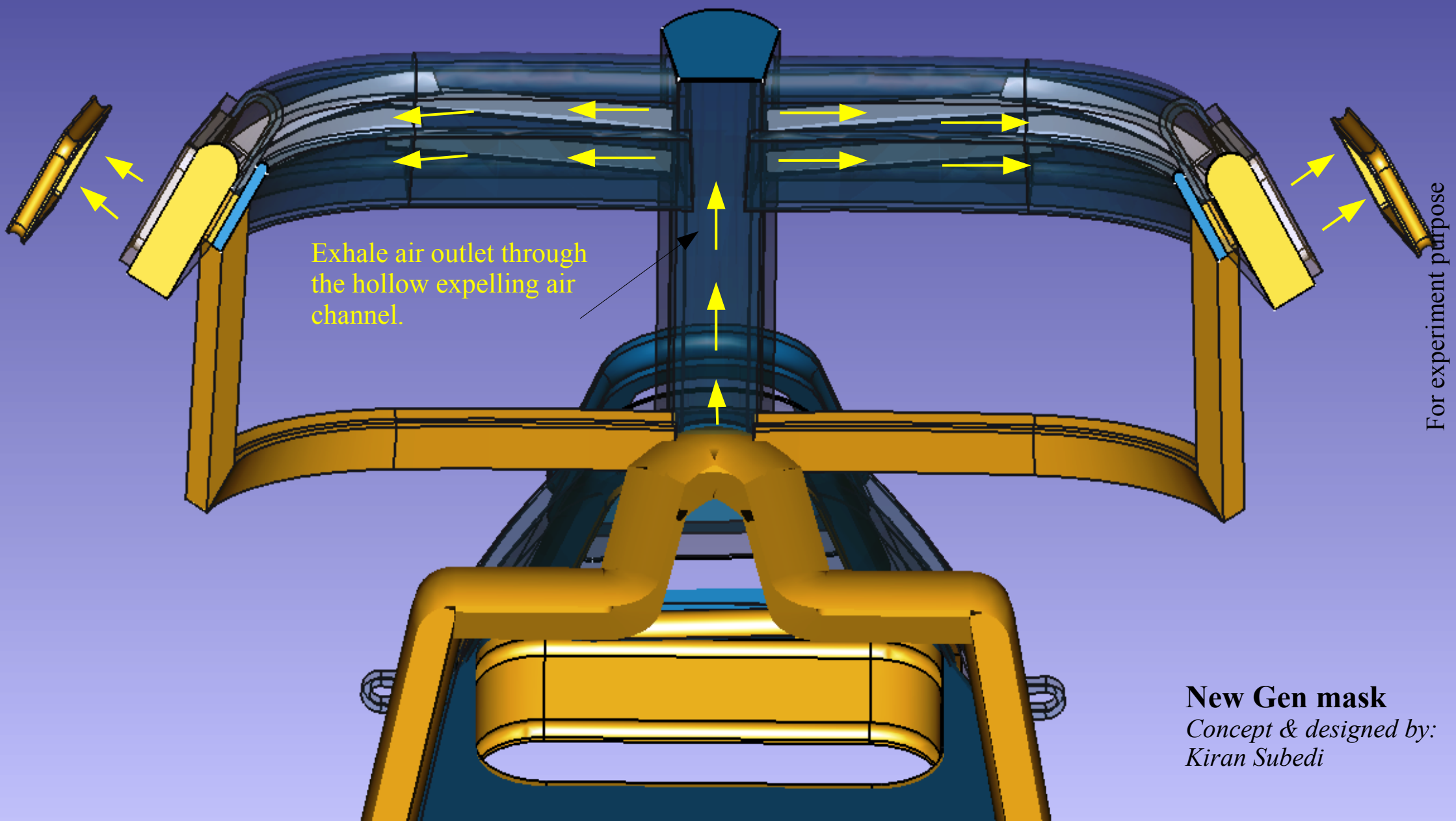

**New Gen mask**  
*Concept & designed by:*  
*Kiran Subedi*

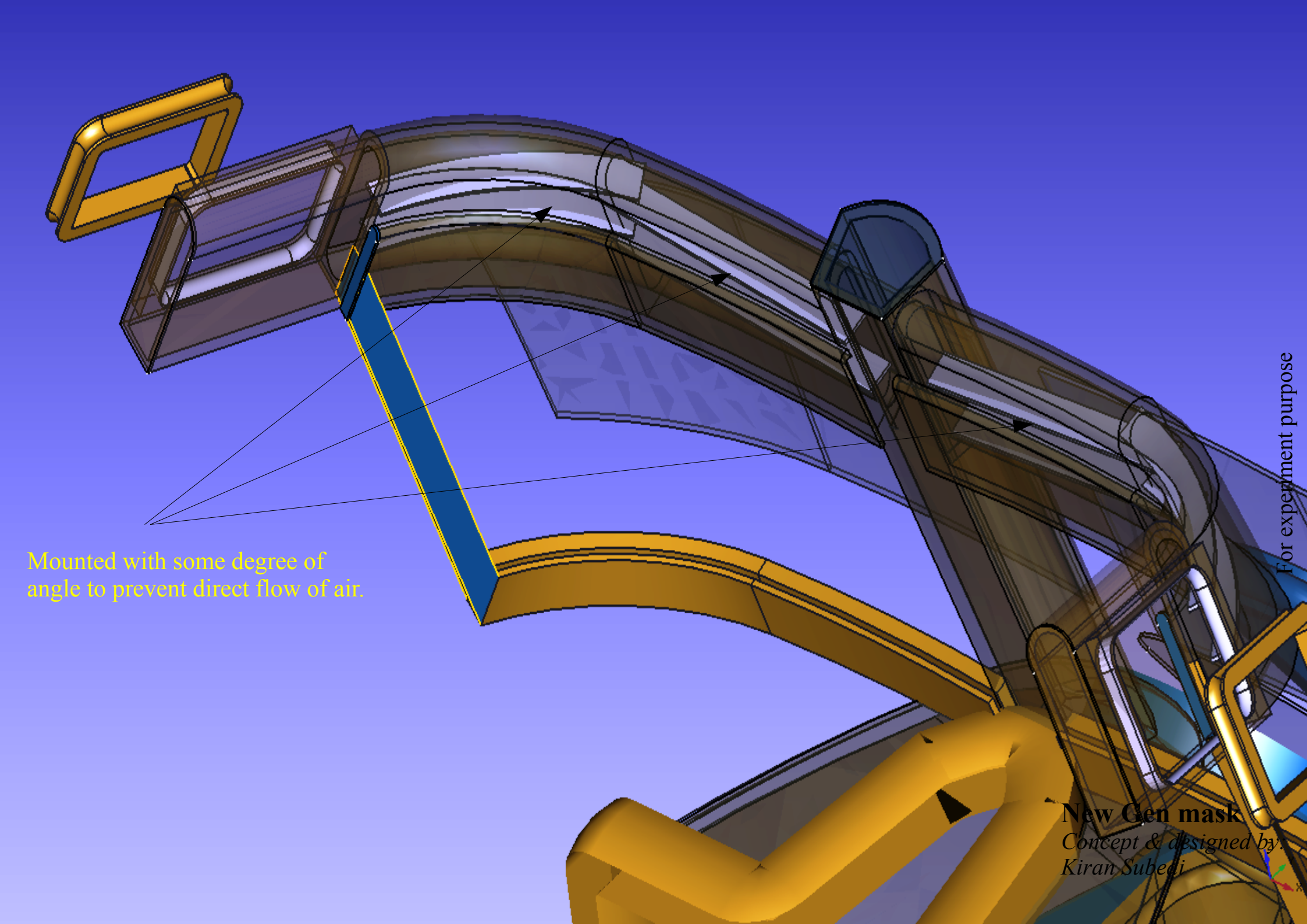

Mounted with some degree of angle to prevent direct flow of air.

For experiment purpose

**New Gen mask**  
Concept & designed by  
Kiran Subedi



**Do not print**

This is transparent plastic sheet. Insert all edges into the slot of the frame.

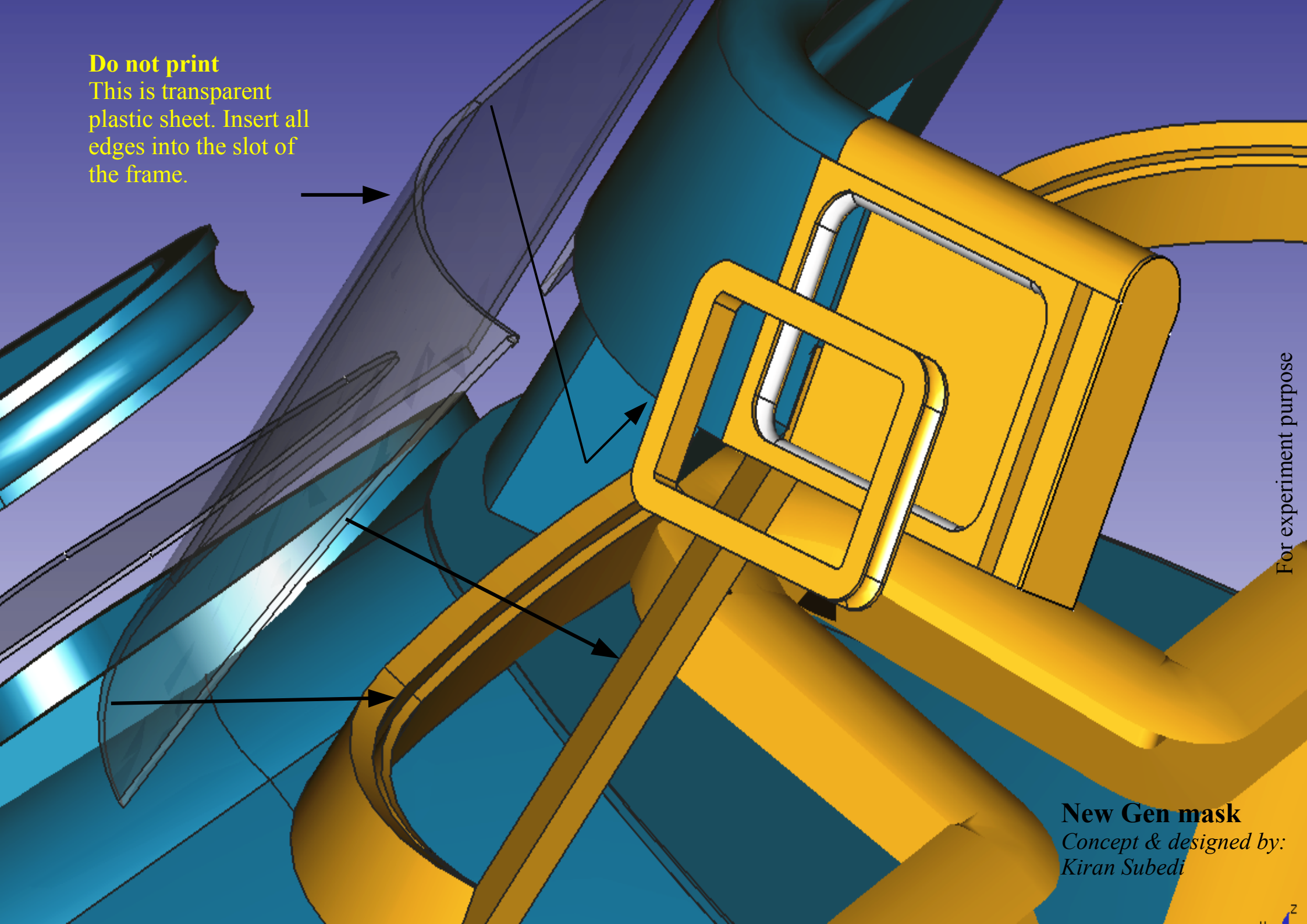

For experiment purpose

**New Gen mask**  
Concept & designed by:  
Kiran Subedi

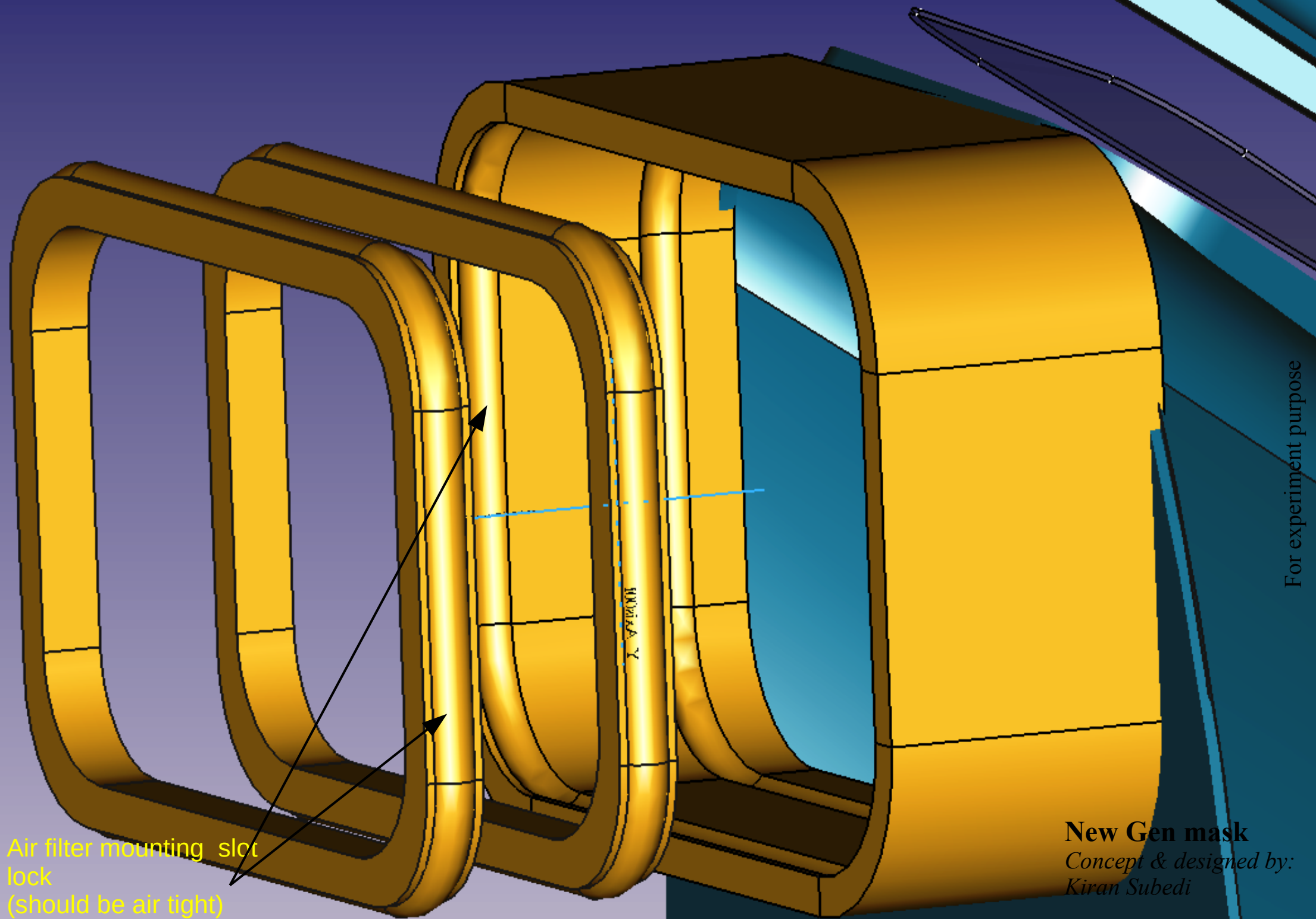

Air filter mounting slot  
lock  
(should be air tight)

**New Gen mask**  
Concept & designed by:  
Kiran Subedi

For experiment purpose

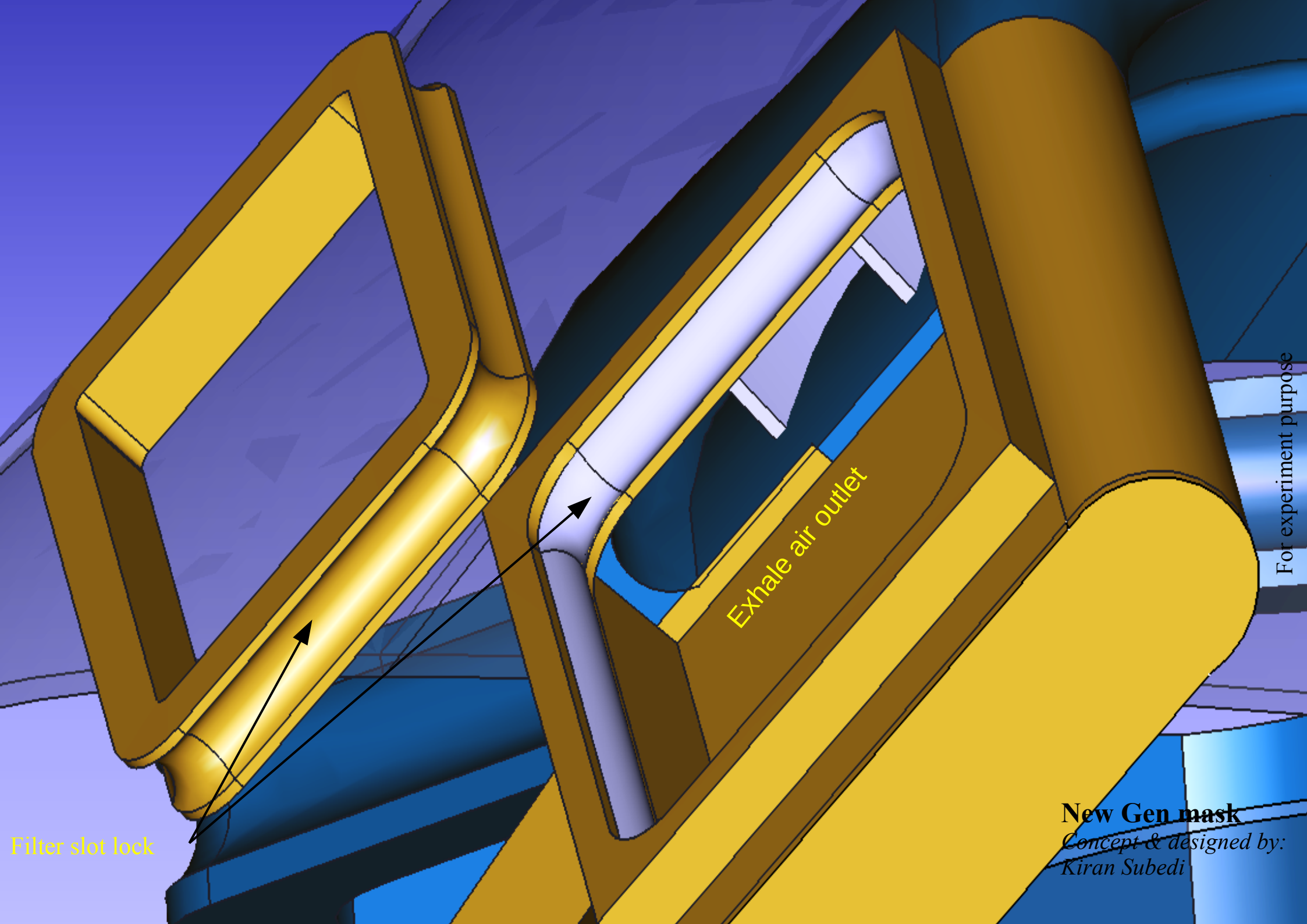

For experiment purpose

**New Gen mask**  
Concept & designed by:  
Kiran Subedi

Filter slot lock

Exhale air outlet



Do not print  
Plastic sheet

Transparent plastic sheet  
Slot lock (should be air tight)

For experiment purpose

**New Gen mask**  
*Concept & designed by*  
*Kiran Subedi*

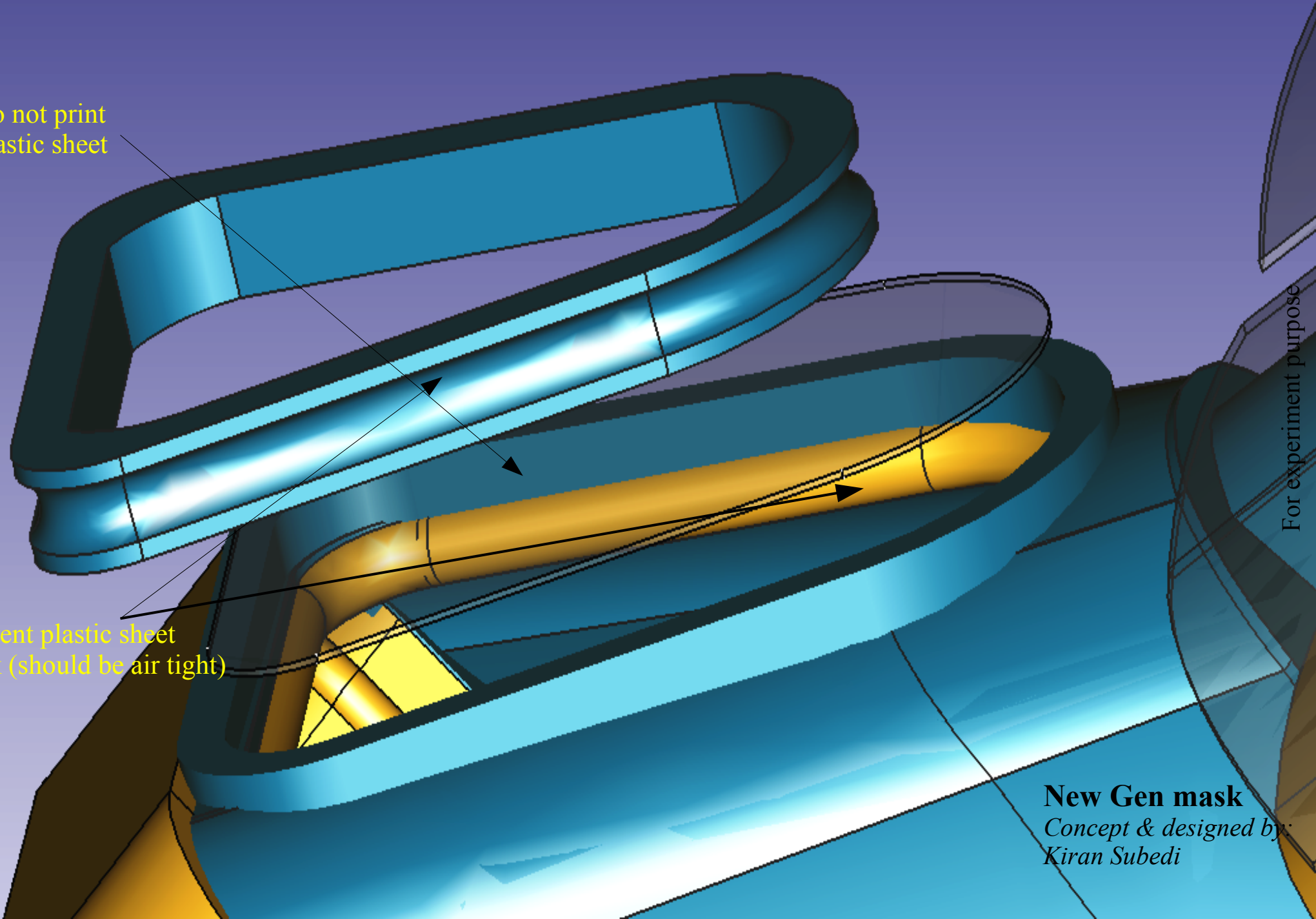



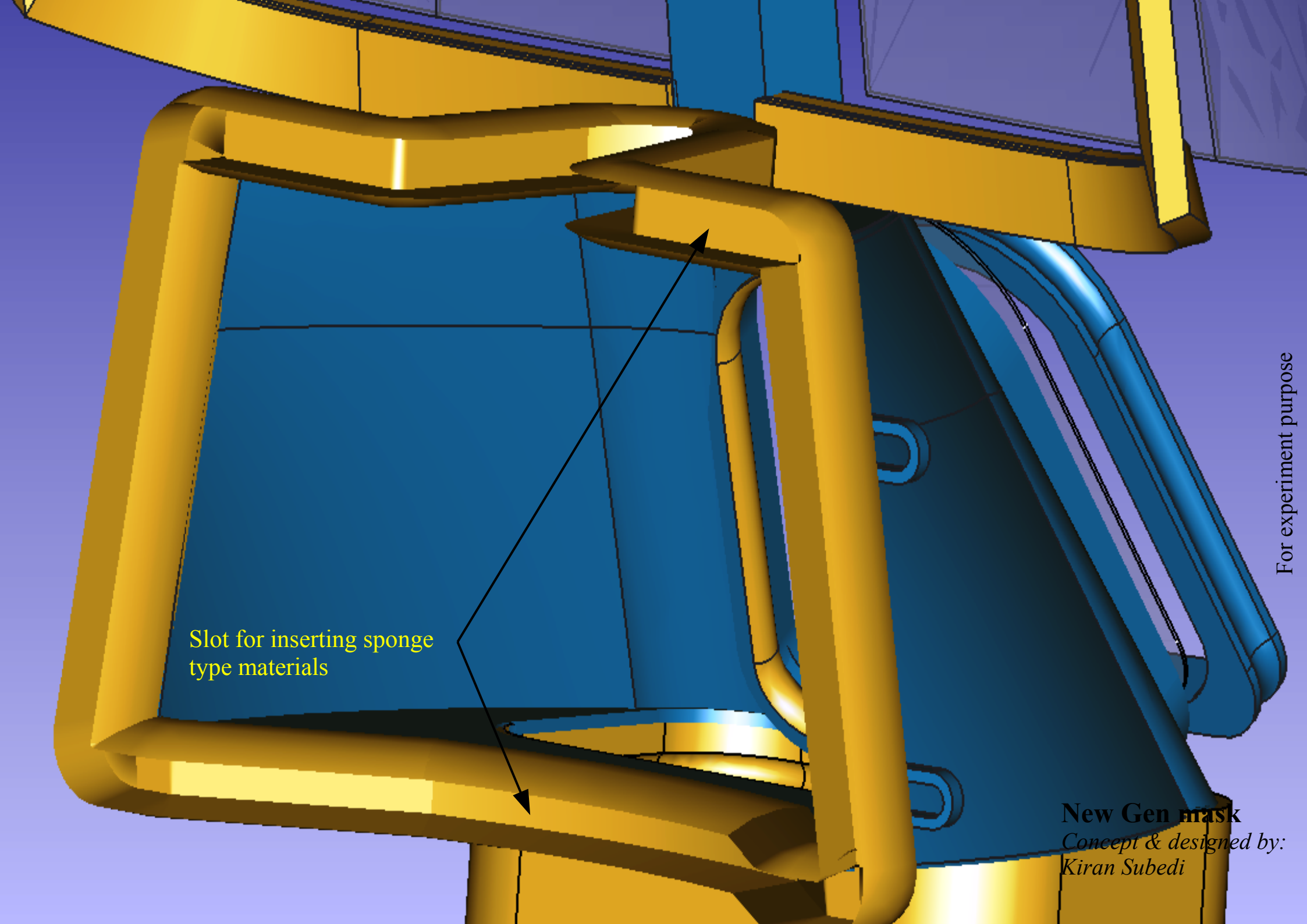

Slot for inserting sponge  
type materials

For experiment purpose

**New Gen mask**  
Concept & designed by:  
Kiran Subedi

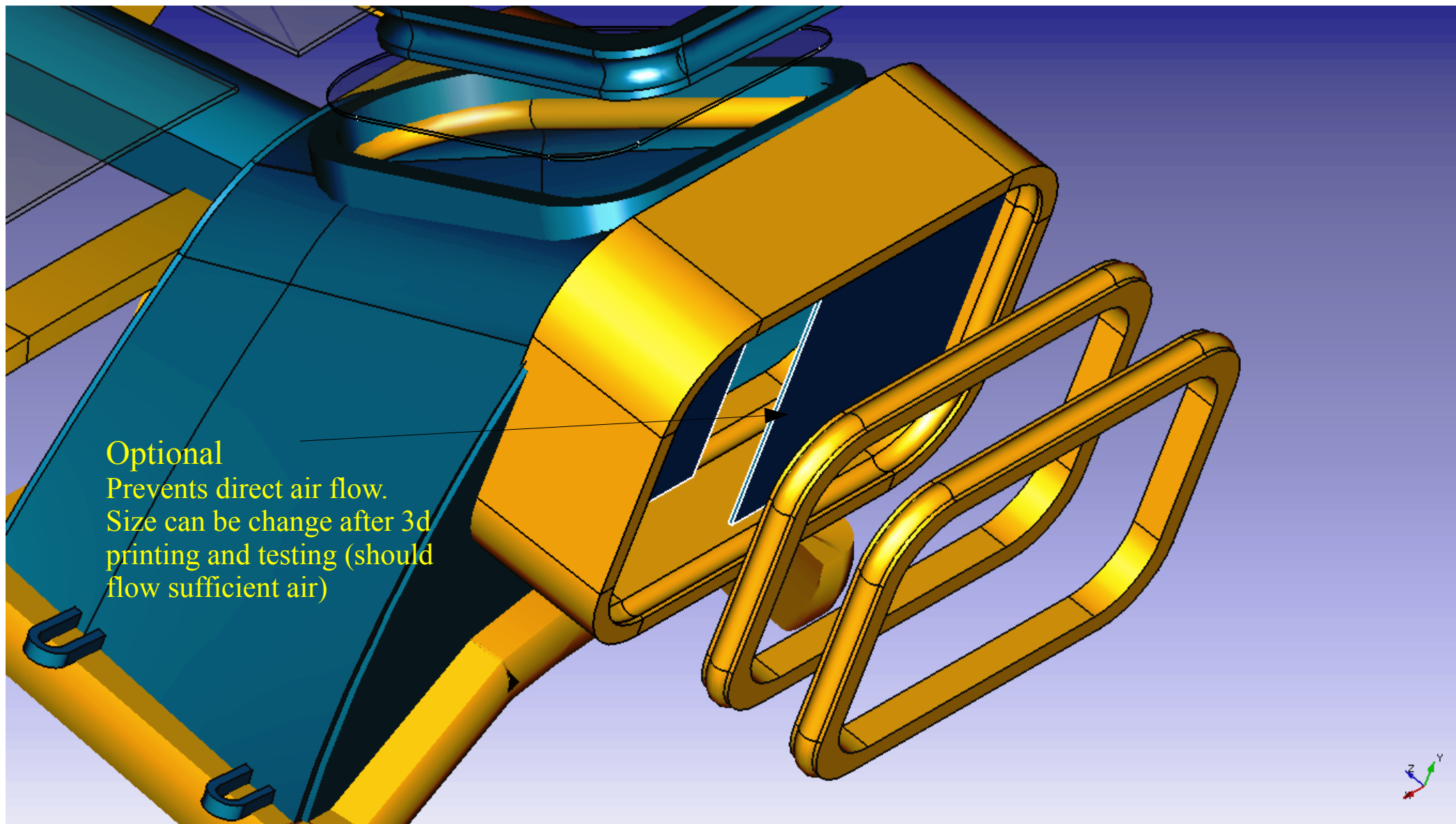

Optional  
Prevents direct air flow.  
Size can be change after 3d  
printing and testing (should  
flow sufficient air)

For experiment purpose

**New Gen mask**  
*Concept & designed by:*  
*Kiran Subedi*

## What is new?

1. Layers of the filter are mounted at the bottom side of the mask. So there is no direct contact with front side. Besides this front side of the mask now can be covered with transparent shield for visibility inside the mask.
2. Filters are placed leaving small space between two filters, so air can be accumulated after first filter before second filter.
3. Sponge type material is inserted inside the slot loop of the mask so there is no room for entering unfiltered air inside the mouth and nose part but eyes are only protected by eye protecting transparent shield if necessary it can be design.
4. No exhale air accumulated infront of the eyes which means there is no condensation of moisture in the transparent shield infront of the eye, so there is clear vision for the eyes.
5. Exhale air is warm and lighter which rises up and passes through the hollow space inside mask and exhausted from the filter mounted at the two sides of frame edges. After testing , if it is necessary to increase the surface area of the filter and filter frame then filter size can be increase in the design

For experiment purpose

**New Gen mask**  
*Concept & designed by:*  
*Kiran Subedi*

